



BICYCLE
ROLLERS

Parts

M6 Nuts x 4

M6 Button head bolt x 4

Rubber foot x 4

Roller x 2

Side rail x 2

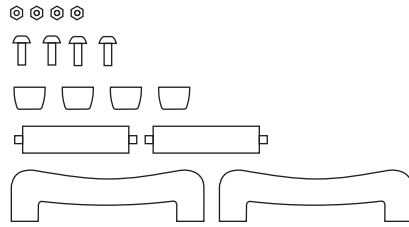

M8 Button head bolt x 4 

Assembly

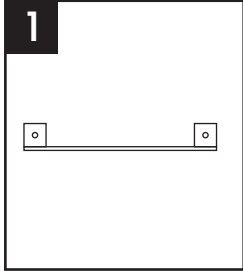

1 Insert M6 bolts into rubber feet. With side rail face up place one rubber foot/ bolt assembly through hole and secure with one nut

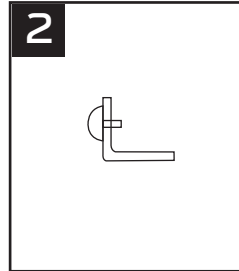

2 With side rail still on its side install the remaining 3 rubber feet and secure with bolts

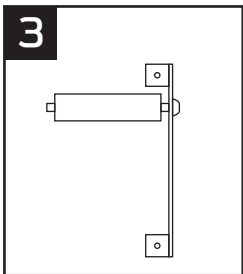

3 Place side rail upright, with rubber feet on the bottom. With logo facing out attach roller to side rail with button head bolt

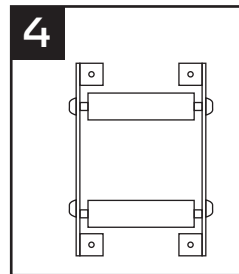

4 Repeat steps to install rollers with the 3 remaining button head bolts

Use

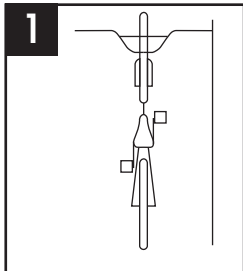

1 Find a sturdy structure, either a wall or chair. Rest the end of the handlebars on the structure. Leave space for pedal rotations.

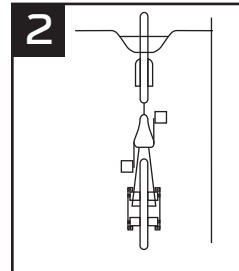

2 One bike is in position place Rexer Roller under the back wheel

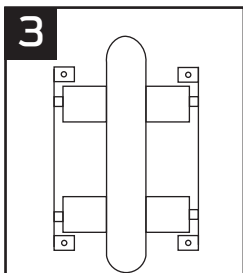

3 Place the rear wheel between the two rollers on the unit, making sure your rear wheel is parallel with the side rails of the unit

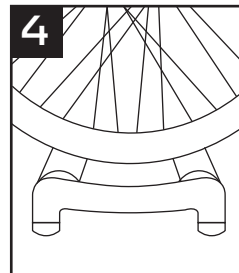

4 Begin pedaling while holding on to the structure. Do not engage brakes while pedaling

Maintenance

If dirty wipe unit off with a damp cloth

Do not rinse with or submerge in water

Avoid using Rexer roller in extremely wet conditions

Keep water way from roller bearing